

Battery drill worm gear winch WA200



Battery drill worm gear winch

Product specifications:

- robust and safe hoisting and pulling winch operated with battery drill
- static safety factor 4
- flexible coupling attachment for battery drill
- self braking worm gear system
- suitable for wall or floor (console) mounting
- suitable for short hoisting lengths
- maintenance free aluminum closed gear box
- in compliance with EN13157 and DIN 15020
- painted frame with thickness 60 - 80 micron in 1 layer and zinc-plated finished cable drum

Accessories:

- steel or stainless steel wire ropes



GEBUWIN
metal products

Industrieweg 6, 7102 DZ Winterswijk, The Netherlands
Telephone: +31(0)543 532600 Email: info@gebuwin.com
For more information: www.gebuwin.com



Technical specifications WA200

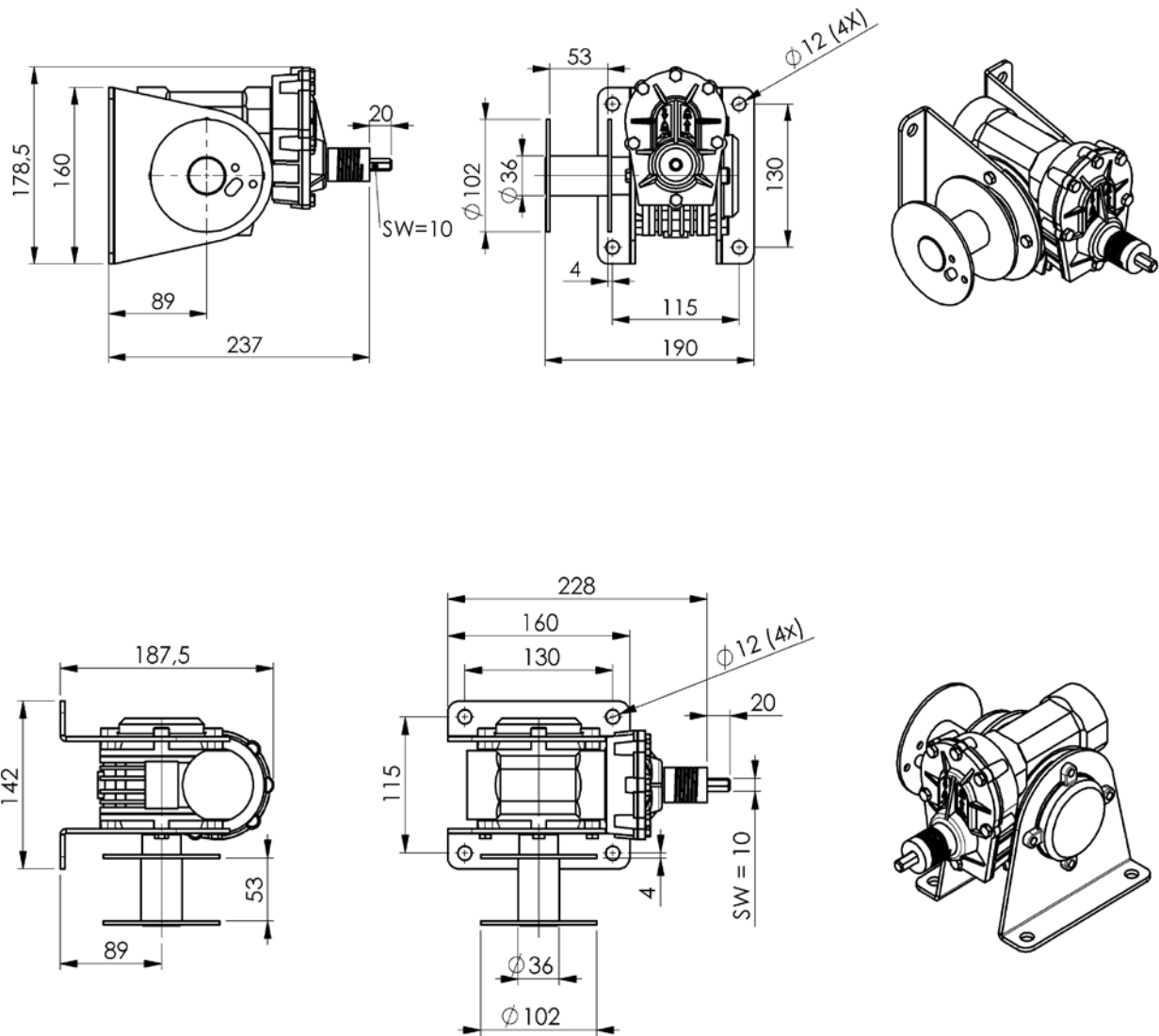

Type	Mounting	Material finish	Remarks
WA200 GR / D	Wall / Floor, 4x M10 class 8.8	Painted finish	RAL 7035 (grey)

Technical specifications		WA200
Capacity 1st cable layer	kg	200
Capacity last cable layer (7)	kg	90
Max. speed drill driver	rpm	1400
Six-angled adapter	mm	10
Max. hoisting speed	mm/min	800
Hoist length with 200 kg and cordless drill 14,4V - 3 Ah	m	8
Cable capacity	m	18
Diameter cable	mm	4
Min. breaking load cable	kN	6
Own weight	kg	6

subject to changes

Form more information: www.gebuwin.com

Drill worm gear winch DW1000



Drill worm gear winch

Product specifications:

- robust and safe hoisting and pulling winch
- in compliance with EN13157, DIN15020
- static safety factor 4
- right angled worm transmission and spur gearing
- cable outlet upwards, downwards or at rear
- drill and hand operated
- adjustable crank with ergonomic grip
- load pressure break with ratchet system
- transmission box IP54
- automatic grease system for the worm gearing
- paint thickness is 60 - 80 micron in 1 layer and in compliance with DIN/ISO 12944, C1M

Options:

- grooved drum
- multiple cable drum compartments

Accessories:

- steel or stainless steel wire ropes



GEBUWIN
metal products

Industrieweg 6, 7102 DZ Winterswijk, The Netherlands
Telephone: +31(0)543 532600 Email: info@gebuwin.com
For more information: www.gebuwin.com



Technical specifications DW1000

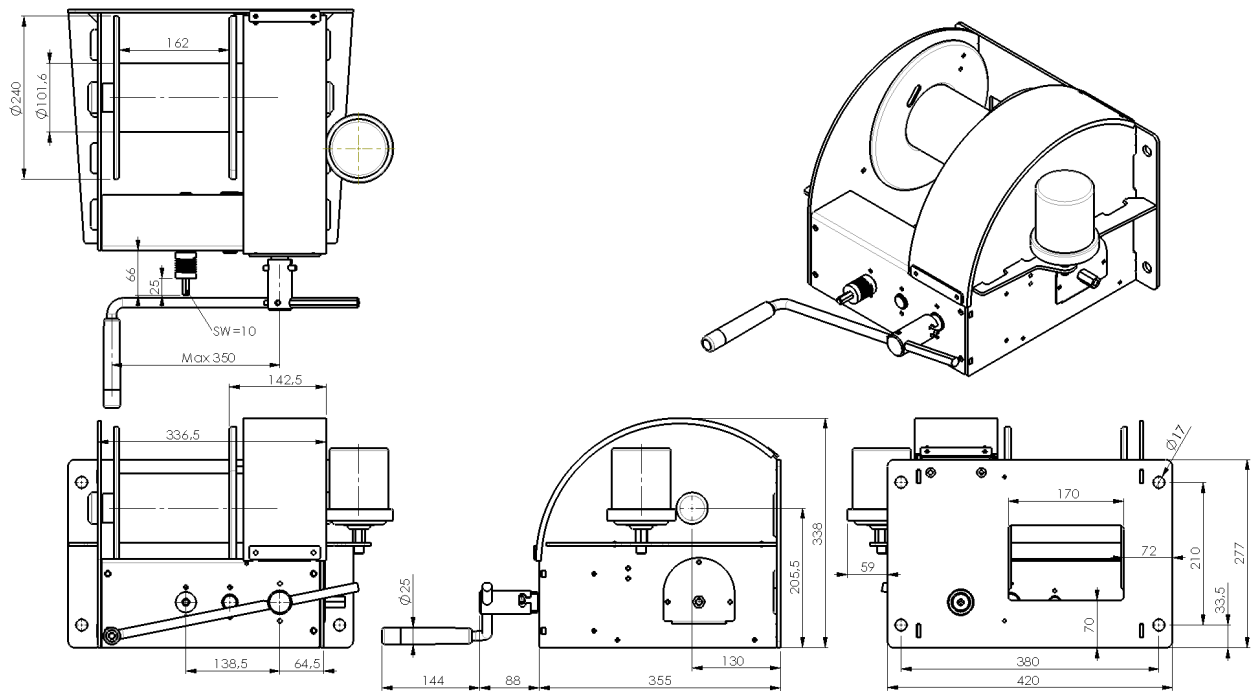

Type	Mounting	Material finish	Remarks
DW1000 GR / D	Wall, 4x M12 class 8.8	Painted finish	RAL 7035 (grey)

Technical specifications			DW1000
Capacity 1st cable layer		kg	1000
Capacity last cable layer		kg	527
Hand operated, 1st layer	Crank force	kg	11
	Hoisting length by one rotation	mm	9 (approx. 0,23 m/min)
Drill operated, 1st layer	Torque in going shaft	Nm	ca. 6
	Max. input rotation speed drill	rpm	650
	Cable speed	m/min	0,6
Battery driven grease system	DC 4,5-5 V, grease EP	cc	125 (approx. for 1 year)
Max. cable storage		m	63
Diameter cable		mm	8
Min. breaking load cable		kN	30
Own weight		kg	39

subject to changes

Form more information: www.gebuwin.com