

**Flat cylinders - spring return**  
**Short stroke cylinders - spring return**

# Feel the **power**

Unique Duo Power  
Ring concept

Extra low construction height

Easy-to-disassemble  
spring return

 **holmatro**  
mastering power

 **holmatro**  
mastering power



## Feel the power

For almost 45 years, our experienced engineers have been combining their energies. Totally inspired to translate innovative ideas into powerful hydraulic solutions for heavy industrial applications. Your wishes and experience as users help determine what we stand for: controlling unprecedented forces cleverly and simply under the most extreme conditions.

Holmatro is a Dutch company that is there to help you worldwide. We produce our groundbreaking equipment and systems ourselves in a state-of-the-art production environment. Commitment, reliability and sustainability are anchored in our corporate philosophy. That's why service, maintenance and certification are also organised down to the last detail. Our stringent inspection specifications are considered the norm in the branch.

Holmatro staff are united behind the user-friendly hydraulic products and systems you use on a daily basis. Naturally, we want to share that proud sense of mastering power with you. Because power is inspiring and challenging. Today, tomorrow and the next day.

## Unique Duo Power Ring concept

The Duo Power Ring concept combines a superior seal with a very strong composite bearing. The seal produces an excellent static and dynamic sealing effect. The composite bearings prevent metal to metal contact. They provide resistance against side load to a maximum of 10%. This unique combination ensures a longer life, so that you as user can benefit from a longer servicing period.



## Flat cylinders - spring return

model	HFC 5 S 0.5	HFC 5 S 1.5	HFC 10 S 1.5	HFC 20 S 1.5	HFC 30 S 0.5	HFC 30 S 1.5	HFC 50 S 1.5	HFC 75 S 1.5	HFC 100 S 1.5	HFC 150 S 1.5
art no	100.112.168	100.112.181	100.112.184	100.112.185	100.112.187	100.112.186	100.112.194	100.112.193	100.112.191	100.112.175
working pressure	bar / Mpa	720 / 72	720 / 72	720 / 72	720 / 72	720 / 72	720 / 72	720 / 72	720 / 72	720 / 72
tonnage	t	5	5	10	20	30	30	50	75	100
stroke length	mm	5	15	15	15	5	15	15	15	15
closed height	mm	31	44	46	55	50	60	71	80	90
capacity	kN/t	50.9 / 5.2	50.9 / 5.2	99.8 / 10.2	203.6 / 20.8	318.1 / 30.7	318.1 / 30.7	510.4 / 52.0	747.9 / 76.2	1030.5 / 105.1
oil content	cm³	4	11	21	42	22	66	106	156	215
effective pressure area	cm²	7.1	7.1	13.9	28.3	44.2	44.2	70.9	103.9	143.1
weight	kg	1.2	1	1.6	2.9	3.6	4.2	7	11	18.1
maintenance set		100.013.128	100.013.128	100.013.132	100.013.134	100.013.150	100.013.150	100.013.155	100.013.156	100.013.157
recommended pump		HTW 300 B	HTW 300 B	HTW 300 B	HTW 300 B	HTW 300 B	HTW 300 B	HTW 300 B	HTW 300 B	HTS 550 B
recommended pump		HTS 550 A	HTS 550 A	HTS 550 A	HTS 550 A	HTS 550 A	HTS 550 A	HTS 550 A	HTS 550 A	HTW 700 A
pressure gauge		A 501	A 501	A 501	A 501	A 502	A 502	A 503	A 503	A 504



## Flat cylinders - spring return (dimensions)

model	HFC 5 S 0.5	HFC 5 S 1.5	HFC 10 S 1.5	HFC 20 S 1.5	HFC 30 S 0.5	HFC 30 S 1.5	HFC 50 S 1.5	HFC 75 S 1.5	HFC 100 S 1.5	HFC 150 S 1.5
A	mm	31	44	46	55	50	60	71	80	90
B / B²	mm	60 / 46	60 / 46	82 / 55	100 / 80	116 / 95	116 / 95	140 / 119	165 / 144	190 / 173
C	mm	25	25	36	50	62	62	75	80	110
D / handle	mm	385 (hose)	76	76	76	76	76	76	76 / 85	76 / 75
E	mm	15	15 (5°)	19	19 (5°)	19 (5°)	19 (5°)	19 (5°)	19	24
F	mm	30	43	46	54	49	59	70	79	88
I₂	mm	-	-	-	-	-	-	-	I₂	I₂
U	mm	29	29	37	49	52	52	67	76	76
V	mm	7	7	7	9	11	11	13	13	13
W	mm	22	22	34	39	44	44	53	66	74

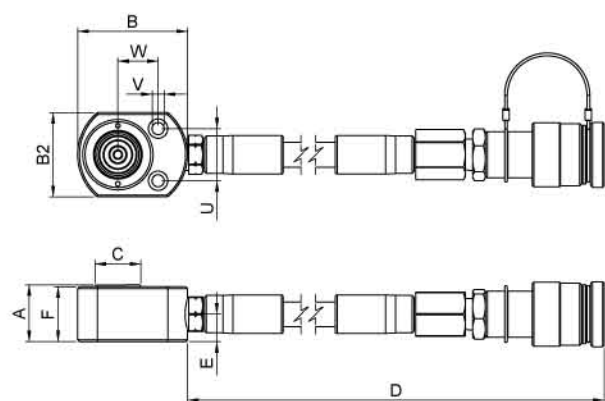

HFC 5 S 0.5

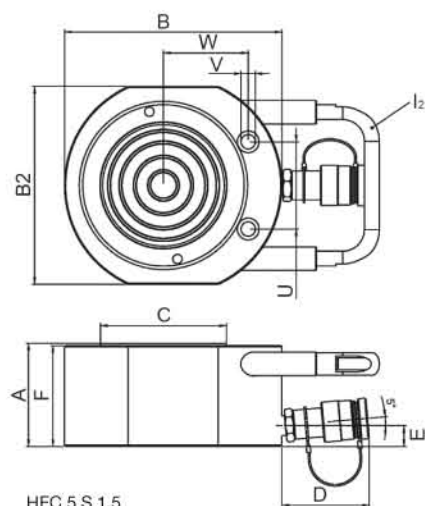

HFC 5 S 1.5  
HFC 10 S 1.5  
HFC 75 S 1.5  
HFC 20 S 1.5  
HFC 30 S 0.5  
HFC 30 S 1.5  
HFC 50 S 1.5  
HFC 100 S 1.5  
HFC 150 S 1.5

## Short stroke cylinders - spring return

model	HSC 10 S 5	HSC 20 S 5	HSC 30 S 5	HSC 50 S 5	HSC 100 S 5
art no	100.112.164	100.112.171	100.112.176	100.112.178	100.112.172
working pressure bars	bar / Mpa	720 / 72	720 / 72	720 / 72	720 / 72
tonnage	t	10	20	30	50
stroke length	mm	50	50	50	50
closed height	mm	100	103	106	117
capacity	kN/t	99.8 / 10.2	203.6 / 20.8	318.1 / 32.4	510.4 / 52.0
oil content	cm³	69.3	141.4	220.9	354.4
effective pressure area	cm²	13.9	28.3	44.2	70.9
weight	kg	2.9	5.5	6.1	9.7
maintenance set		100.013.160	100.013.161	100.013.164	100.013.165
recommended pump		HTW 300 B	HTW 300 B	HTW 300 B	HTS 550 A
recommended pump		HTS 550 A	HTS 550 A	HTS 550 A	HTW 700 A
pressure gauge		A 501	A 501	A 502	A 503



## Short stroke cylinders - spring return (dimensions)

model	HSC 10 S 5	HSC 20 S 5	HSC 30 S 5	HSC 50 S 5	HSC 100 S 5
A	mm	100	103	106	117
B	mm	70	98	104	128
C	mm	36	60	62	75
D	mm	77	77	76	76
E	mm	15 (5°)	15 (5°)	19	19
F	mm	99	102	105	116
I₂	mm	-	-	-	I₂

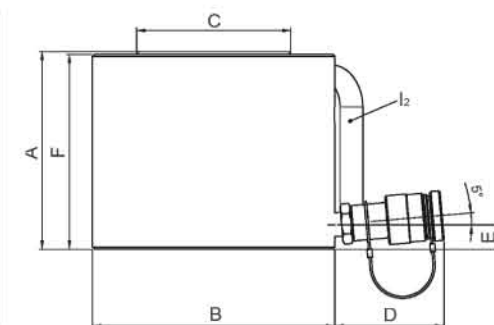

## Easy to use thanks to the extra low construction height.

The **flat** cylinders with spring return were specially constructed for use where the construction height is very restricted and other cylinders don't fit. The new generation of **short stroke** cylinders was designed for situations with a restricted construction height, which call for a small stroke. Both types of cylinder can be used in the most diverse situations and comply with the ASME B-30.1 standard. That therefore means dynamism, ease of use and safety under all conditions.

## Extra handy: easy-to-disassemble spring return

Both the **short stroke** and the **flat** cylinders are fitted with a spring that pulls the plunger back after use. With average use, Holmatro recommends servicing once a year. This frequency could be higher if you use the cylinders more often under extreme conditions. To make maintenance and servicing easier, both cylinders have a spring that can be disassembled quickly and safely.





**Holmatro Netherlands | Industrial Equipment**

PO Box 66  
4940 AB Raamsdonkveer  
Nederland  
T +31 (0)162 - 75 15 00  
F +31 (0)162 - 75 15 99  
E [industry@holmatro.com](mailto:industry@holmatro.com)

**Holmatro U.S.A.**

Glen Burnie, MD 21061  
E [industrial@holmatro-usa.com](mailto:industrial@holmatro-usa.com)

**Holmatro Poland**

Warsaw, Poland  
E [info@holmatro.pl](mailto:info@holmatro.pl)

[www.holmatro.com](http://www.holmatro.com)



Scan the Holmatro  
company video

©Holmatro 00 0312 980.000.392

**Disclaimer**

While the greatest care has been devoted to the content, it is possible that the information in this printed matter is incorrect or incomplete. Holmatro N.V. and its affiliated companies (hereafter: Holmatro) cannot be held liable in any way for the consequences of activities undertaken based on this printed matter. If you have any doubts about the correctness or completeness of the information, you shall contact Holmatro (phone number: +31 (0)162-751500). Nothing from this printed matter can be copied and/or made public in any way without the explicit authorisation of Holmatro.