



# EUROSTYLE<sup>®</sup>

## H<sub>2</sub>O Range

Jib and gantry cranes for  
water treatment applications

 **VERLINDE<sup>®</sup>**  
LIFTING EQUIPMENT



**Ideal for use in water treatment stations, industrial processes, sludge handling and in agriculture, the EUROSTYLE H20 range of jib and gantry cranes is easy to transport and can be handled by a single person.**

By procuring all the components of your lifting rig (jib, hoist, winch, cable, etc.) from the same supplier, you can be sure of the rigorous quality and perfect match-up of the entire assembly.

Once the lifting rig is installed, you will discover that servicing is kept to a strict minimum. The combination of materials that are both extremely robust and lightweight, along with the ease-of-use of our products, facilitates not only maintenance but also keeps down the number of operators required for doing the work.

#### > **Non-corroding materials**

The EUROSTYLE H20 range of jib and gantry cranes from VERLINDE are made of non-corroding materials, and have an extra layer of protection (on certain models of the range) via a coat of epoxy paint.

This choice of sturdy materials and the unique design of our lifting rigs makes them easy to use and reliable.

#### > **Modularity**

A particular feature of our range of jib cranes is that they can be moved around thanks to a range of multi-position bases (wall-hung, embedded or bolted to the ground).

#### > **A wide choice of sizes**

The lifting rigs offer a broad choice of load and span capacity. The jib crane range comprises two basic families: aluminium or galvanised steel (a stainless steel version is also available).

Galvanised support rail  
and chain hoist  
for lifting and moving  
engines

Aluminium jib  
cranes and hoists  
for handling pumps





Aluminium jibs and winches for periodic lifting of agitators

The EUROSTYLE H20 range is designed for a wide variety of applications in the processing of raw sewage, industrial processes, construction, agriculture and aquaculture.

#### > Wastewater processing

- Pumping stations
- Water and rainwater tanks
- Biological sludge processing
- Primary sludge processing
- Secondary sludge processing
- Digested sludge processing
- Sludge storage tanks
- Homogenisation tanks



#### > Industrial processes

- Paper industry
- Mixing paints and dyes
- Chemical industry
- Other industrial homogenisation processes



#### > Sludge processing

- Storage for homogenisation and thickening of sludge
- Digester
- Degassing and mixing with lime

#### > Agriculture

- Slurry
- Biogas
- Pisciculture





# > EUROSTYLE ALU

## H<sub>2</sub>O range

### VEFP type

#### > Technical features

- > Portable aluminium jib crane, 360° rotation.
- > Adjustable span, up to 1.50 m overhang.
- > Load range 300 or 500 kg (according to model).
- > Jib in 3 or 4 pieces, rapid assembly.
- > Easy displacement and storage thanks to its transport bag(s).
- > Highly flexible rotation thanks to the bearing-mounted pivot.
- > Anodised RAL powder paint (durable, impact-resistant).
- > 2 possible heights thanks to 2 different extension pieces (supplied as standard).
- > Supplied with 2 stainless steel shackles for connecting hoist or accessory.
- > Dead load of each element : less than or equal to 24 kg.
- > CE-certified material.

#### > Benefits

- > Equipment designed for use in aggressive atmosphere such as sewage works.
- > Personnel required for assembly : 1 person.
- > Span can be adjusted by 1 person.
- > Disassembles into 3 or 4 elements and can be easily transported (by 1 person) and stored.
- > Cost-effective, since this mobile lifting system can be transported easily on various bases.

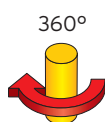



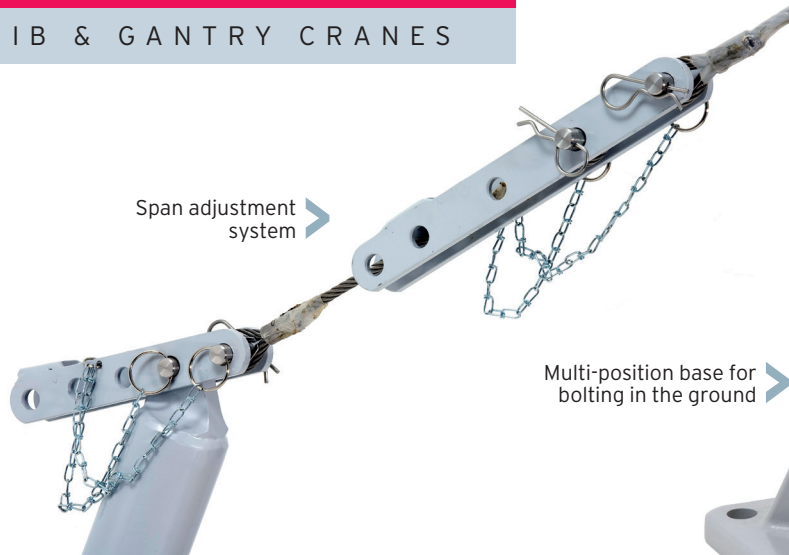

Multi-position base for bolting in the ground



## Options available

- > VHR manual hoist for lifting loads.
- > Standard manual winch system for lifting loads.
- > Manual winch system for lifting persons, with anti-drop device.
- > Wide range of aluminium, stainless steel or galvanised bases for bolting or embedding (ground or wall fixture).
- > Mounting kit
- > Jib height adjuster (various heights).

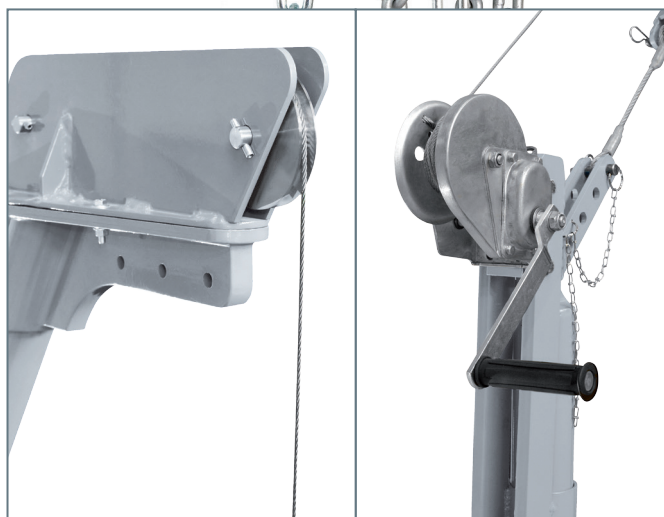

Winch version jib crane with return pulley on the jib arm





# > EUROSTYLE GALVA

## H<sub>2</sub>O range

### VEFPT type

#### > Benefits

- > Equipment designed for use in aggressive atmosphere such as sewage works.
- > Personnel required for assembly : 1 person.
- > Span can be adjusted by 1 person.
- > Disassembles into 4 elements and can be easily transported (by 1 person) and stored.
- > Cost-effective, since this mobile lifting system can be transported easily on various bases.

#### > Technical features

- > Portable galvanised steel jib crane, 360° rotation.
- > Span : variable according to load from 0.5 to 1.5 m.
- > Under-beam height : 2.88 to 3.26 m.
- > Load capacity : 500 kg.
- > Electrogalvanised pivot mounted on lubricated bearings.
- > Load rotation effort : less than 200 N.
- > 2 collapsible, removable tubular manoeuvring handles.
- > Manual hoist with galvanised chain lever for jib arm orientation.
- > Nylon return pulley.
- > Flat textile strap guy line.
- > Each element has a textile transport handle.
- > Lacquered wood storage box.
- > CE-certified material.



Winch version jib crane with return pulley on the jib arm

#### > Options available

- > VHR manual hoist for lifting loads.
- > Manual hoist for lifting loads.
- > Wide range of aluminium, stainless steel or galvanised bases for bolting or embedding (ground or wall fixture).
- > Mounting kit
- > Ri2 paint with 6-year warranty.
- > ATEX or stainless steel version jib

Multi-position base for bolting in the ground



360°



# > EUROSTYLE VEP

Manually movable stainless steel or galvanised steel jib crane range for loads of 125 to 250 kg

Designed especially for maintenance applications on pumps, agitators, etc. The specs of the VEP jib crane range are the result of collaboration between top French engineering companies specialising in water treatment and VERLINDE.

The main specs along with the meticulous production and inspection criteria ensure that the VEP jib crane is endowed with remarkable qualities, such as are essential in water treatment handling operations. Its all-stainless steel manufacturing also makes it suitable for applications in the field of agri-food.



## > Technical features

- > Easy relocation of the jib crane on to other fixed post bases.
- > Available as a galvanised steel version or as a 304 L entirely stainless steel structure. Ideal in corrosive environments (including the multi-position base and chemical anchors).
- > Rounded base. Moly/graphite greasing of the casing rings, ensuring even smoother rotation.
- > Two handles for easy transport and rotation.
- > Standardisation enabling complete interchangeability : Span from : 800 to 1000 mm. Load : up to 250 kg.
- > Installation : Single multi-position base for attachment to concrete surface, using a wall fixture, or embedded into an anchor post.
- > CE-certified material.





# > PORTIQUE ALU

## VGPA type

Ultra-lightweight, manually movable range of gantry cranes for loads of 250 to 2,000 kg



VERLINDE gantry cranes, on account of their innovative construction, offer ease-of-use and easy relocation, while remaining in strict compliance with safety requirements.

Mobile and ultra-lightweight, VERLINDE gantry cranes can be moved from post to post, thereby offering an excellent alternative to fixed lifting systems.

With the VERLINDE range of autonomous manual gantry

cranes, it is child's play for maintenance operatives and assembly teams to carry out the assembly, disassembly and positioning of parts or assemblies.

This standard range of gantry cranes is designed to accommodate any lifting device, and the VERLINDE gantry crane can be equipped with a manual or electric chain hoist.



### > Technical features

- > Lightweight, user-friendly, corrosion-resistant construction.
- > Easy assembly by means of bolting system (8 bolts linking foot and beam). The gantry crane is delivered dismantled with its set of bolts, and can be assembled rapidly.
- > Excellent load stability and rigidity due to the gantry crane design : 2 pairs of V-shaped brace rods and cross brace.
- > EUROSISTEM ALU profile used as travelling beam.
- > The gantry is delivered as standard with a hoist trolley for hollow section members.
- > Extremely simple adjustment of the under-beam height (from 1.55 to 4 m) in steps of 200 mm and of base width (from 2 to 6 m) according to model.
- > Collapsible wheels for transportation.
- > 4 white polyamide wheels with 2 locking wheels as standard.
- > Maximum lifting speed = 8m/min.
- > CE-certified material.

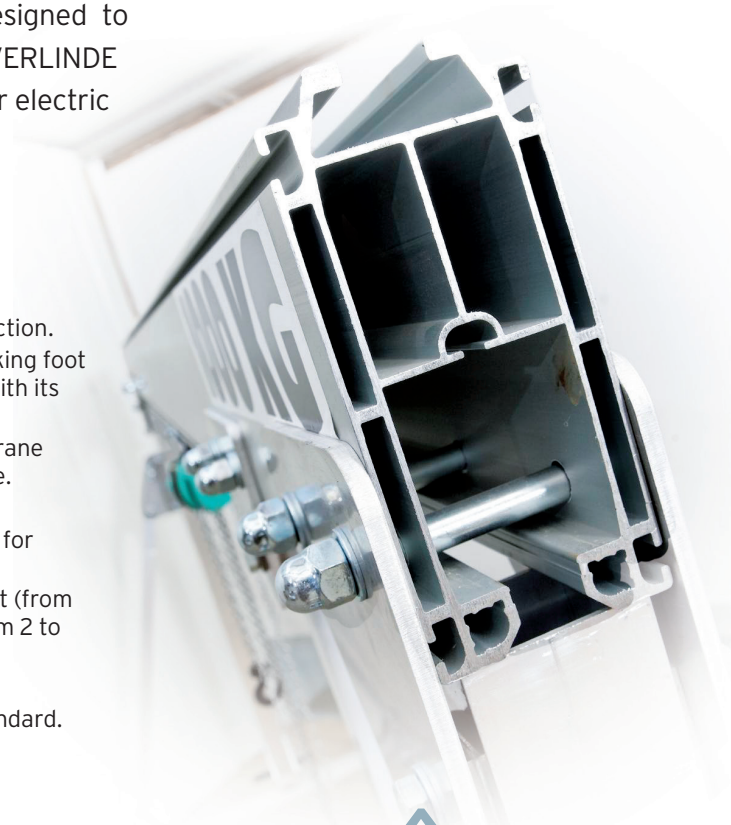

EUROSISTEM ALU  
Aluminium profile used  
as travelling beam





Under-beam height adjustment system

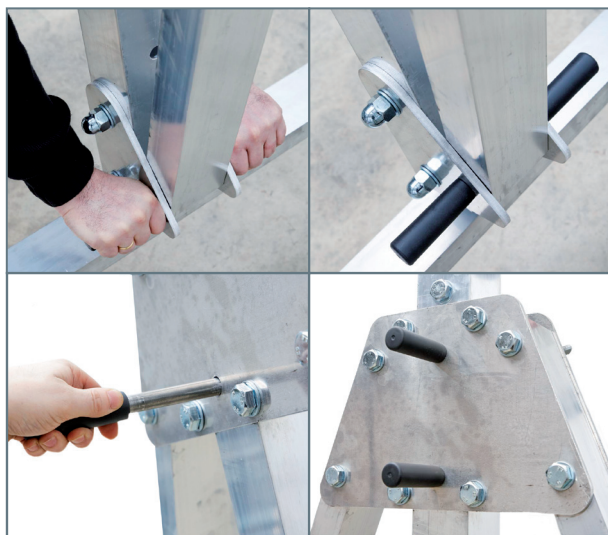

## Benefits

- > Equipment designed for use in aggressive atmosphere such as sewage works.
- > Personnel required for assembly : from 1 to 3 persons according to model.
- > Under-beam height and base width adjustable by 1 person.
- > Great manoeuvring flexibility thanks to its light weight.
- > Disassembles into 3 elements and can be easily transported (by 1 person) and stored.
- > Cost-effective, since this mobile lifting system can be transported easily on various installations. Furthermore, this gantry crane needs no addition of a hoist in order to be used since the direction trolley is already included in the system.
- > Excellent mobility and stability thanks to the four pivoting wheels on bearing axles and yokes. The white polyamide construction of the wheels makes them extremely resistant to impact and chemical agents.

Base width adjustment system

## Options available

- > Electric or manual hoist.
- > Hoist power supply line.
- > Polyurethane tyre wheels.
- > 2 additional locking wheels.
- > Non-pivoting wheels.
- > Dimensions adaptable to requirements.





# > VHR

## Hand chain block for loads of 250 to 5000 kg

### > Technical features

- > The load wheel and the reduction gear are machined in order to ensure more efficient and smoother operation during lifting manoeuvres.
- > Standard lifting height : 3 meters (other heights available on request).
- > High resistance category 80 steel alloy lifting chain with galvanised finish ensuring corrosion resistance.
- > The compact design of the VHR makes it possible to obtain a smaller and lighter apparatus. This hoist is ideal for maintenance applications.
- > The steel cover ensures solid protection for the mechanical components (load wheel, cogs, etc.).
- > Top and bottom steel alloy hooks with safety latches.



### > Options available

- > CHD type manual travelling trolley.
- > Stainless steel lifting chain.
- > Chain bag.
- > VHR with short headroom trolley (HPR).
- > VHR version Ex - ATEX.



**CHD**  
Manual trolley



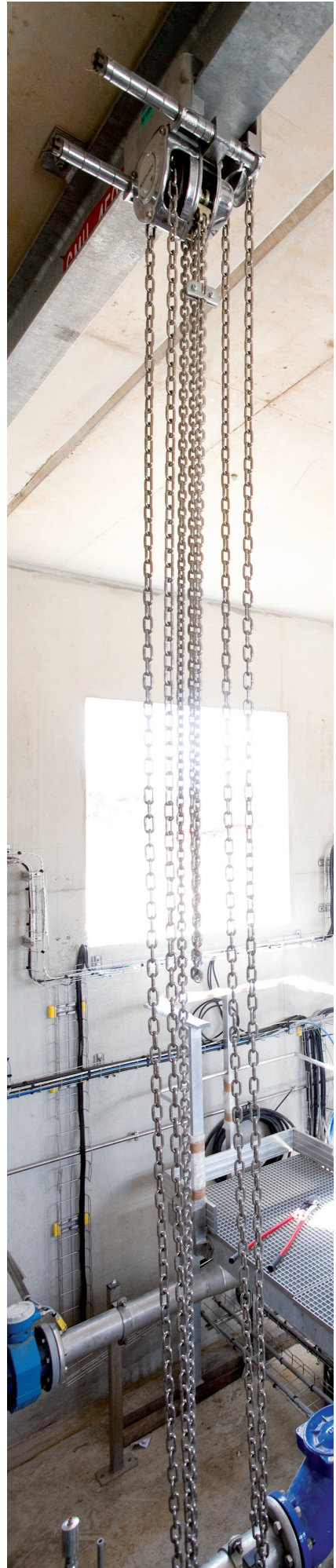







# > EUROCHAIN VR

## Electric chain hoist for loads from 63 to 5000 kg

Completely innovative, top of the range design, its fluid, contemporary and elegant lines confirm the power of this electric chain hoist. This new generation of EUROCHAIN VR hoists is the result of innovative technology ; new materials, new operating concepts, can adapt to each specific need.

### > Technical characteristics

The EUROCHAIN VR electric chain hoist is designed to provide users with the maximum level of safety. It is delivered with the following equipment as standard :

- > New lifting nut concept with intermediate teeth for perfect chain drive.
- > Torque limiter.
- > Disk lifting brake.
- > 3m standard lifting height.
- > Dual-speed lifting.
- > Safety electric end of run for up and down position.
- > IP55 lifting and travelling motor.
- > Thermal protection on lifting motor.
- > Tropic-proof protection (lifting and steering - 90 to 95 %).
- > Galvanised lifting chain.
- > Disconnectable command cable.
- > 2-buttons unit on fixed hoist or push steering carriage.
- > 4-buttons unit on hoist coupled to electric steering carriage.
- > "Punch" emergency stop button.
- > 400V/3Ph/50Hz or 415V/3Ph/50 Hz or 460V/3 Ph/60 Hz power supply.
- > Low voltage 48 V command.
- > Chain bag.
- > 70 mm, RAL 7021 epoxy powder paint.
- > Speed variation on travelling - MS Mode (for hoists with an electric trolley).
- > Complies with the CE machine directive.



### > Options available

- > Gear limit switch.
- > Second brake on lifting motor.
- > Attachment by eyelet (perpendicular) to replace the upper hook.
- > Automatic closure lifting hook.
- > Travelling limit switch.
- > Short headroom trolley.
- > Trolley for curved track.
- > Dual-speed travelling trolley carriage (20 & 5 m/min).
- > Slow speed travelling trolley (3 to 10 m/min).
- > High speed travelling trolley.
- > Additional button on pendant unit.
- > Wall-mounted command.
- > Direct voltage hoist control to replace the low voltage.
- > Manual brake release.
- > Rain protection.
- > Reinforced protection.
- > Total protection for operation in Zone 22.
- > Reinforced tropic-proof protection.
- > Hoist available in a version that complies with CSA standards.





In order to satisfy your every need, Verlinde also proposes a wide range of manual winches, traditional jib cranes, overhead handling systems, travelling crane components, clamps and clamshell, and so on.



Manual winches

Templiers type jib crane range



Hollow profile rails for overhead handling



Electric wire rope hoists equipped with clamps or clamshell







Partially or totally slewing jib crane range



Components for travelling cranes





## VERLINDE is:

- The leading French manufacturer and exporter of lifting and handling equipment.
- A comprehensive range of 30 groups of lifting equipment from 60 to 250,000 kg.
- ISO 9001 Quality control certified and ISO 14001 Environmental Management Systems.

## In France:

A sales network and after sales service points, EUROPONT travelling crane construction plants and a distributor network.

## Abroad:

A customer service in more than 92 countries.

## References

**Metallurgy, Mechanics, Nuclear**  
ArcelorMittal, Unimetal, Stein, NFM,  
Framatome, Alstom

**Chemicals, Petrochemicals industry**  
Sanofi Aventis, Total,  
Du Pont De Nemours

**Aeronautical industry**  
Aérospatiale, Airbus,  
Snecma, Eurocopter,  
Air France, Aéroport de Paris,  
Dassault Aviation



**Agri-food industry**  
Nestlé, Danone, Bel, Palamatic,  
Tetrapak, Lactalis

**Automobile industry**  
Renault, Peugeot, Citroën, Scania,  
Ford, RVI, Volkswagen, Michelin,  
Massey Fergusson, Manitou,  
Toyota Industrial Equipment

**Other sectors**  
EDF, SNCF, RATP, Spie, Degremont,  
Eiffage, Polysius, Baudin Chateauneuf

 **VERLINDE**<sup>®</sup>  
LIFTING EQUIPMENT

NEXT LEVEL  
PARTNERSHIP

2, boulevard de l'Industrie | B.P. 20059 | 28509 Vernouillet cedex | France  
Phone : (33) 02 37 38 95 95 | Fax : (33) 02 37 38 95 99 | Internet : [www.verlinde.com](http://www.verlinde.com)

